

## TECHNICAL MANUAL

### DIRECTION, USE AND MAINTENANCE



**MOD. TURNER INOX**

**BIDIRECTIONAL TURNSTYLE**

INFORMATIONS IN THIS TECHNICAL MANUAL CAN BE MODIFIED WITHOUT NOTICE. ANY REFERENCE TO FIRMS, NAME, DATA AND ADDRESSES IS MERELY ACCIDENTAL, IF NOT DIFFERENTLY STATED. IT HAS THE ONLY AIM TO SHOW THE USE OF THE PRDUCT.

NOTHING IN THE MANUAL CAN BE REPRODUCED IN ANY FORM, ELECTRONIC OR MECHANIC, FOR ANY USE, WITHOUT THE PERMISSION.

WE DECLINE ANY RESPONSIBILITY FOR TROUBLES CAUSED BY POSSIBLE MISTAKES, INACCURANCIES AND OMMISSIONS HERE INCUDED.

## **PREMISE**

WITH THIS MANUAL THE CONSTRUCTOR FIRM WANTS TO SHOW FEATURES AND TECHNICAL QUALITIES, INSTALLATION PROCEEDING AND MAINTENANCE ROUTINES OF THE MACHINE.

WE INCLUDE THE ELECTRIC DIAGRAMS, THE PLANS OF MECHANICAL AND SPARE PARTS.

TO OBTAIN THE HIGHEST EFFICIENCY AND DURATION WE SUGGEST ALL THE USERS AND UPKEEPERS READING THIS MANUAL AND PAYING SCRUPULOUS ATTENTION TO THE RULES OF USE AND MAINTENANCE HERE DESCRIBED.

## **GUARATEE**

AS SOON AS THE MACHINE IS DELIVERED IT'S BETTER TO CHECK IF IT HAS NOT BEEN DAMAGED DURING THE TRANSPORTATION OR ANY OF THE FITTINGS AND OPTIONALS YOU REQUIRED ARE MISSING.

POSSIBLE COMPLAINTS MUST BE COMMUNICATED IN WRITING TO THE CONSTRUCTOR FIRM IN 8 DAYS TIME.

THE GUARANTEE OF THE BIDIRECTIONAL **TURNSTYLE MOD. TURNER INOX** HAS THE DURATION OF 12 MONTHS.

## 1. DESCRIPTION OF THE MACHINE

### 1.1 GENERAL PREMISE

FOR SPECIAL MAINTENANCE UNDER GUARANTEE PLEASE REFER EXCLUSIVITY TO THE MANUFACTURER.

THE MANUFACTURER IS NOT RESPONSIBLE OF ANY IMPROPER USE OF THE MACHINE, MODIFICATIONS, SUBSTITUTIONS OF ORIGINAL PARTS OF IT WITH OTHERS IF NOT EXPRESSLY ALLOWED BY THE MANUFACTURER ITSELF.

### 1.2 TECHNICAL FEATURES

HEIGHT	mm. 980
THICKNESS	mm. 900
WIDTH	mm. 740
NET WEIGHT	Kg. 50
VOLTAGE	V dc 24
ABSORPTION	
NORMAL WORKING	mA 100
ENTRANCE UNLOCK	mA 500
ENTRANCE/EXIT UNLOCK	mA 1000

### 1.3 DIMENSION AND EXTENSION

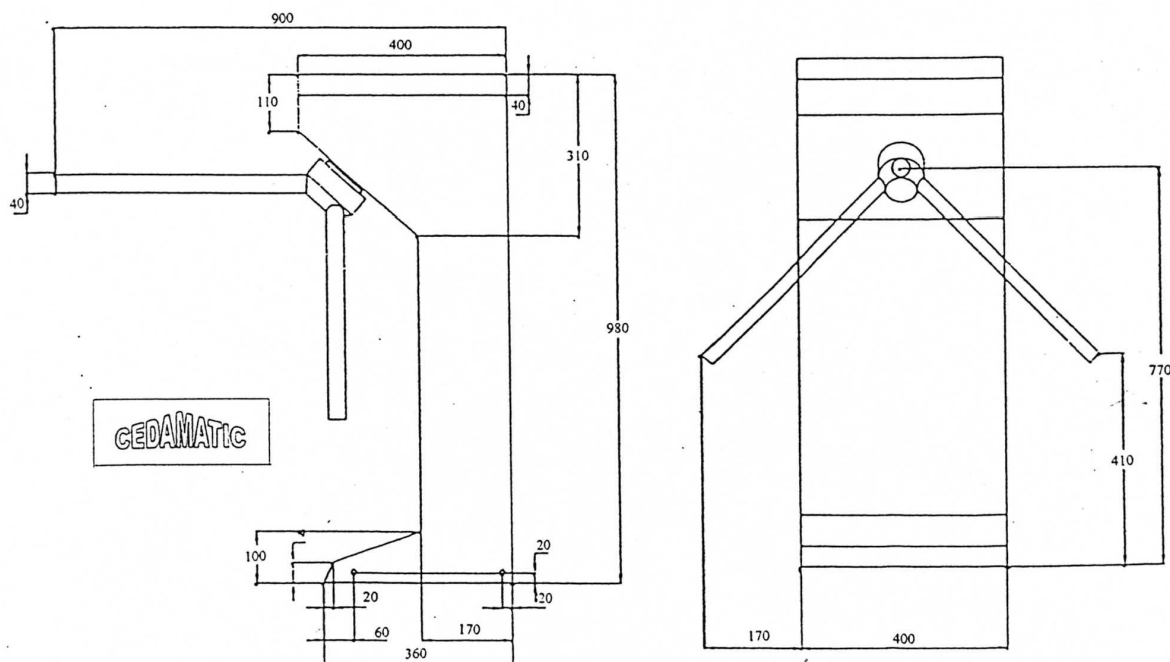

## 2. INSTALLATION PROCEEDING

### 2.1 GENERALITY

THE BIDIRECTIONAL TURNSTYLE MOD. TURNER TR.3PV3 IS NOT DIFFICULT TO INSTALL, IT IS SUFFICIENT TO FOLLOW THE ELECTRIC DIAGRAM REPORTED BELOW AND TO CONNECT THE CONNECTORS PAYING ATTENTION TO THE LABELS.

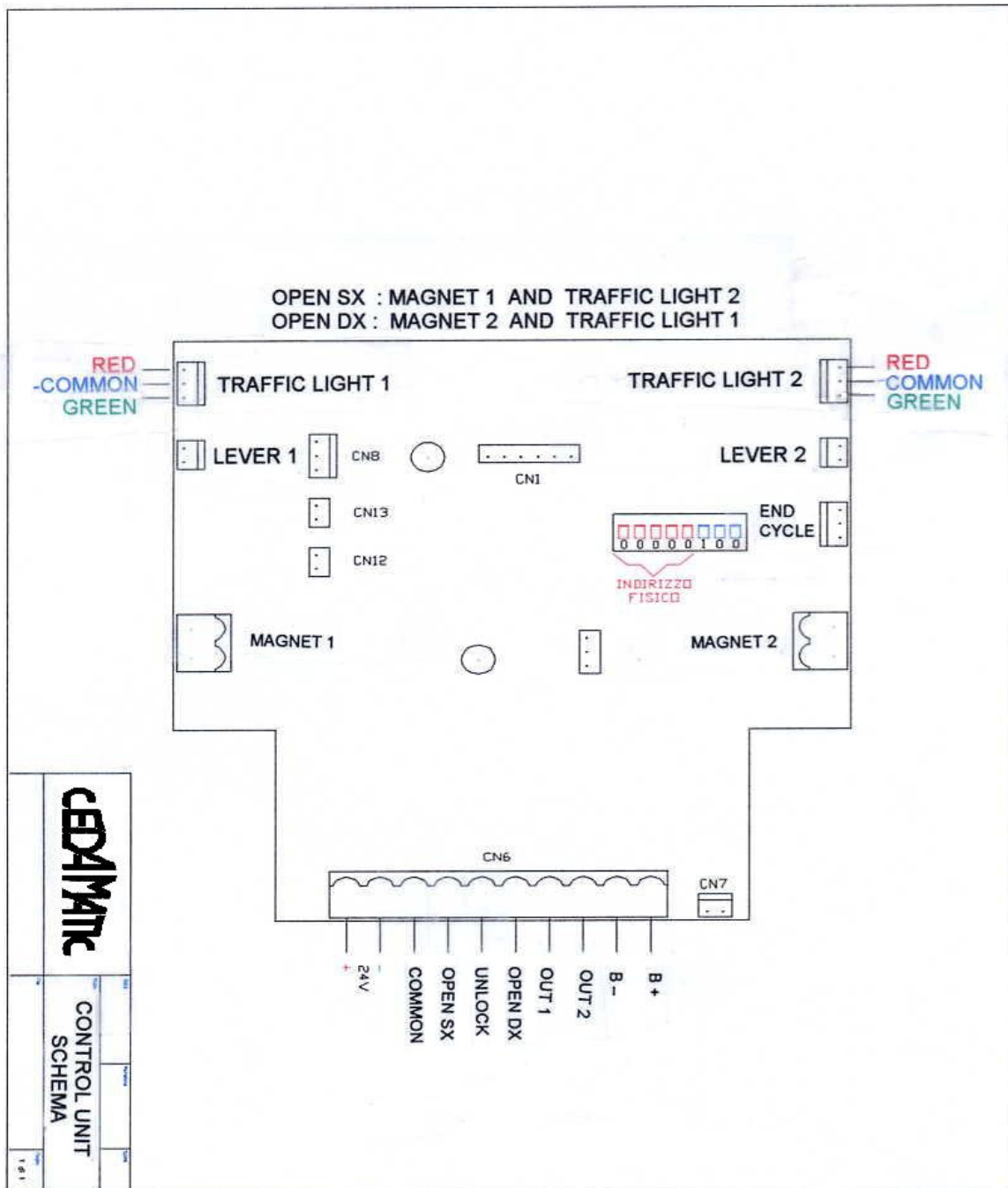

### 3. MAINTENANCE

#### 3.1 ORDINARY MAINTENANCE

THE BIDIRECTIONAL TURNSTYLE DOES NOT NEED OF ANY ORDINARY MAINTENANCE. INSIDE THERE ARE TWO SPRINGS TO RELEASE MANUALLY THE ARMS.

#### 3.2 EXTRA-ORDINARY MAINTENANCE

SOME PARTS OF THE MACHINE CAN BE SUBSTITUTED DIRECTLY BY THE FINAL USERS. THESE COMPONENTS ARE :

- LEDS
- MICRO LIMIT SWITCH
- ELECTRO-MAGNETS

##### 3.2.1 REPLACEMENT OF LEDS

TO SUBSTITUTE THE LEDS, AFTER OPENING THE COVER OF THE TURNSTYLE , IT IS SUFFICIENT TO DISCONNECT THE CORRESPONDING CONNECTORS (RJ11) OF THE LED FROM THE PRINTED CIRCUIT AND PRESS THE LED FROM INSIDE TO THE OUTSIDE OF THE TURNSTYLE.

AT THIS STAGE PULL OUTSIDE THE CABLE OF THE BROKEN LED AND INSERT THE NEW LED UNTIL THE CLICK; LINK THE CONNECTOR TO THE PRINTED CIRCUIT, THEN CLOSE THE COVER AGAIN.

##### 3.2.2 REPLACEMENT OF MICRO LIMIT SWITCHES

OPEN THE COVER AND DISCONNECT THE CONNECTOR (RJ11) CORRESPONDING TO THE DAMAGED MICRO, UNSCREW THE TWO FIXING SCREWS OF THE MICRO LIMIT SWITCH, THEN INSTALL THE NEW ONE. CONNECT THE CONNECTOR AND CLOSE THE COVER.

##### 3.2.3 REPLACEMENT OF ELECTRO-MAGNETS

OPEN THE COVER AND DISCONNECT THE TERMINAL CORRESPONDING TO THE DAMAGED ELECTRO-MAGNET UNSCREW THE TWO FIXING SCREWS OF THE ELECTRO-MAGNET AND, IF NECESSARY, UNSCREW ALSO THE PIVOT-ONES. INSERT THE NEW COMPONENTS FIXING SCRUPULOUSLY THE SCREWS, RECONNECT THE ELECTRICAL TERMINAL THEN CLOSE THE COVER OF THE TURNSTYLE.

Con la presente dichiariamo che il nostro prodotto  
We hereby declare that our product

---

**MOD. TURNER-INOX**

è conforme alle seguenti norme:  
complies with the following:

Direttiva sulla compatibilità elettromagnetica (89/336/CCE)  
EMC guidelines (89/336/EEC)

Norme armonizzate applicate in particolare:  
Applied harmonized standards, in particular:

---

**EN 50081-1****EN 50082-1**

---

**15/11/2003**

**Data/Firma**

---



**CEDA S.R.L.**

Via L.L. Zamenhof, 464

36100 Vicenza Italy

Tel. 0444/241094 – Fax 0444/240736